

The BUSY Schools Cairns Campus: Newsletter

Term 1, Week 2

Friday 2nd March 2024

In this issue:

- Curriculum and Assessment News
- Belated Year 11 Awards from 2023
- What is Stress?
- Year 11 and 12 Maths
- Employment and Vocational Pathways News
- Thank You

A note from the Campus Principal

A very large mention of thanks needs to begin our newsletter as we have started the year in such an extraordinary way and there has been a lot of confusion for everyone. Thank you to the students, the parents and carers, the staff, and the wider school community for your much appreciated support and patience as we muddled through the last two weeks. A special thank you to the Skill360 staff that are based in building behind the school. They have been very patient with us while our orders, staff and students have somewhat invaded their space. They have also assisted us with some of our organizational needs. Given the situation, we have had quite a smooth start to the year, and it can only improve from here.

As of today, our timetables are back to normal, and we can stop texting and emailing updates to you all. We will be working in demountables and classrooms, but the program can run as usual. We are excited about that!!!

Naomi Vucas
Campus Principal

Curriculum and Assessment News

Even amongst our modified timetable, our students have been studiously working. The next two years are very different to what many of students are used to. In Year 11 and Year 12, curriculum and assessment flow through all year, not just at towards the end of the term. It is important that students attend all classes even the ones in the last week of term. You will find assessment planners and term planners attached, but you can also locate them in Compass.

Assessment Calendar Term 1 Year 11 2024

Term Week	Essential English	Essential Mathematics	Social & Community Studies	Visual Arts in Practice
Week 1 22– 26 Jan Public holiday 26/01				Unit 1 Option D Transform and Extend - Project (collage/abstraction) Hand out Assessment – ODD WEEKS
Week 2 29 Jan – 2 Feb				Unit 1 Option D Transform and Extend - Project (collage/abstraction) Hand out Assessment – EVEN WEEKS
Week 3 5- 9 Feb				

Assessment Calendar

Term 1 Year 12 2024

Term Week	Essential English	Essential Mathematics	Social & Community Studies	Visual Arts
Week 1 22– 26 Jan Public holiday 26/1				Module 5 Unit 3: Pieces of us – Project (collage/abstractic Hand out assessme ODD WEEKS
Week 2 29 Jan – 2 Feb				Module 5 Unit 3: Pieces of us – Project (collage/abstractic Hand out assessme EVEN WEEKS
Week 3 5 – 9 Feb	IA1 Extended Response starts			Checkpoint 1 – consult concept and planning ODD WEEKS

Belated Year 11 Awards from 2023

Thank you to everyone who attended our belated awards yesterday, students, family, staff and the Honorable Warren Entsch, member for Leichhardt. It is the second-best part of our job to be able to celebrate all the success stories with you. The best part of the job is laughing with the students and supporting them each day. As soon as we have the photos back, we will send a link out and families and support people can download photos that they would like.

We look forward to seeing you all again at the end of the year for Graduation!!!

What is Stress?

Stress is a response to external challenges, like deadlines or difficult decisions. Stress is normal, and it can sometimes be good. Most of the time, the things that cause stress aren't dangerous. Often, stress is caused by everyday things, like taking a test, getting called on in class, awkward situations, or having too much to do. Too much stress, however, can be overwhelming and it can make it hard for people to enjoy life. Knowing the signs of stress can help us know how to intervene, quickly and stay calm and focused.

Stress for teens

- School
- Social challenges
- Relationships
- Negative thoughts or feelings about themselves
- Extracurricular activities
- Work
- Transitions (eg. graduating, moving out, living independently)

Managing stress

Stress can be managed by talking with trusted people, spending time with friends or family, and embracing healthy lifestyle choices.

- Getting enough sleep
- Exercising regularly
- Listening to music
- Eating a healthy diet
- Practicing visualisation
- Calming breathing techniques
- Being organised

What if stress is too much to handle?

Most of the time, everyday stress comes from challenges you can face and deal with. But if your stress feels too strong, happens too often, or feels like more than you can handle, talk to a trusted person to get help and support.

BUSY Schools Youth Workers, Marney, Amber and Hannah are available at any time throughout the day in the chillout room and appointments can be made through our Youth Workers with our provisional Psychologist and Health Practitioner at BUSY Health, located near the reception desk.

GRADE 12 MATHS

How much cement do you need for a retaining wall?

Students have been faced with a massive problem; when building a large retaining wall, how much cement will be needed to hold the timber stumps in place?

For this real life problem, students were given a scenario where they had to solve the volume of 2 meter deep cylindrical holes in the ground, the volume of the cylindrical timber stumps, and the volume of cement that would fill the hole to hold these stumps in place.

The first few were easy... but when there were 32 to do... students went to the power of the spreadsheet to solve this massive problem in a fraction of the time.

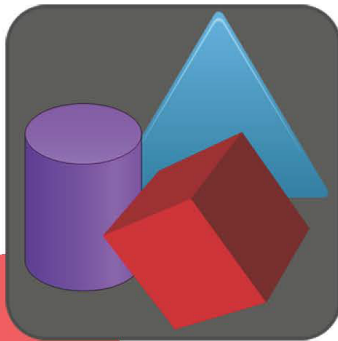

Solving 2 & 3 Dimensional Shapes

To start the year, students are practicing their formulas. Remember $A = l \times w$ and $V = 1/2 \times b \times h \times H$ and the rest of them?

You'll be a little bit sympathetic to the kids this week for having to remember how to match up the right variables to the correct side of the shape and entering all the digits into the calculator in the right order, and finally, interpret the correct units.

You gotta love maths!

Designing & Painting a House

Students will be designing the shape and floorplan of a small house. They will need to apply their imagination and visualize the structure of their buildings and determine the size and arrangements of the rooms.

From there, they will determine how much paint would be required to cover the internal and external walls by calculating the area of the walls.

This can be a long and complex task but an excellent life skill to have.

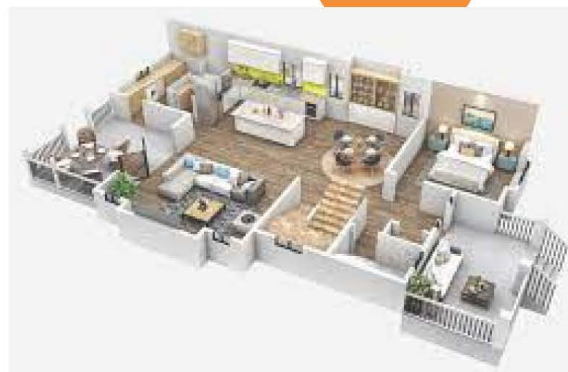

11 ESSENTIAL MATHS



Term 1 this year Year 12 students will be working with ratios, rates, percentages, fractions and representing data.

When in life do we use ratios?

Who has a 2 stroke mower? Mixing oil with petrol is measured with a ratio. Ratios are also used when adding cleaning oils or chemicals to water, or splitting costs when budgeting for household food.

When in life do we work with rates?

Rates are part of everyday life. Wages are rates. With paid employment, you usually know your hourly rate, like how many dollars you earn per hour, for example, \$26/hr.

Think of the fuel consumption of cars. Some cars get 100kms/L. Or, how fast can you go down the highway? We refer to rates often. For example, the number of heart beats per second, cost of fuel per litre or cost of data per gigabyte.



Percentages are next and again, we use them so often.

When we shop, we are always looking for a sale and the discounts are often displayed as percentages.

Student exam results are also converted to percentages %.



The representation of data is the next topic on the agenda. Students learn to identify different types of graphs and interpret the data presented. It's a busy term, and attendance is so important to keep up to date for the final exam at the end of the term. Best of luck grade 11s!



Employment and Vocational Pathways News



Welcome to 2024. We have met quite a few of our new students but wanted to introduce ourselves properly.

Sheree – Work Readiness Officer (left)

Sheree runs the Busy Schools to Work and S.E.L.F Programs for all our students. Sheree is also the person to talk to about short courses – *First Aid, White Card and Responsible Service of Alcohol*. Sheree can be contacted on 0474 083 907 or sheree.millard@busyschools.com.au

Amanda (middle) and Amba (right) – Employment Pathways Officers

As EPOs, Amanda and Amba, assist students with anything relating to their future pathways. This includes:

- Certificate I, II or III courses at school
- Work Experience
- Traineeships or apprenticeships
- Discussions with employers
- University or TAFE applications
- Blue cards, tickets and licences for employment
- Jobs boards of local employers looking to hire. This will be posted on compass on a Monday

Amanda can be contacted on 0419 852 844 or amanda.lines@busyschools.com.au

Amba can be contacted on 0456 627 481 or amba.tipton@busyschools.com.au

We look forward to working with you all throughout your schooling. Feel free to talk to us around your classes or even send a text through.

A Thank You to Naomi

As a staff we wanted to acknowledge the incredible job Naomi has done keeping the school going over the last few months and being a supporting, caring and dedicated boss. We know she goes above and beyond for us, the whole school community, students, families, and staff included. We banded together and surprised her with a bunch of flowers, in her favourite colour, a gift and a card with messages from all the staff (pretty hard to get everyone to fill in a card in this place!). She has been working day and night to make sure we have classes running smoothly, including timetables that varied day to day, and hasn't batted an eyelid! She just gets on with it and we appreciate everything she does for us. We as a staff want to thank her for being her! Thank you Naomi.





Google Review

Have you noticed a positive change in your teen since they started attending The BUSY Schools? Would you like to share this with others?

Please leave us a review on our Google page to help others decide if The BUSY Schools is the perfect solution for their teen.

To leave a review, visit <https://g.page/r/CUkV7U-PMCUEEBM/review>.

Feedback Process

At The BUSY Schools we want everyone to have a voice! We want to hear any compliments and/or concerns. The best way for feedback to be effective is to pass it through the most relevant channels. If you have anything you need to express, you could:

- Approach the relevant people directly and have a respectful conversation to resolve the incident;
- Approach Anne English to discuss the issue; and/or

Report the feedback on the BUSY Schools Website:
<https://www.busyschools.qld.edu.au/busy-schools-feedback/>



Connect with us



/busyschools



/busyschools



www.busyschools.qld.edu.au